

Brick tray

Lintel to suit 215x102 - full bricks

Section at span

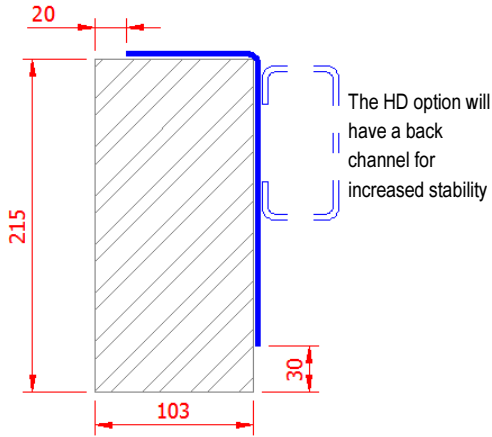

Section at bearing

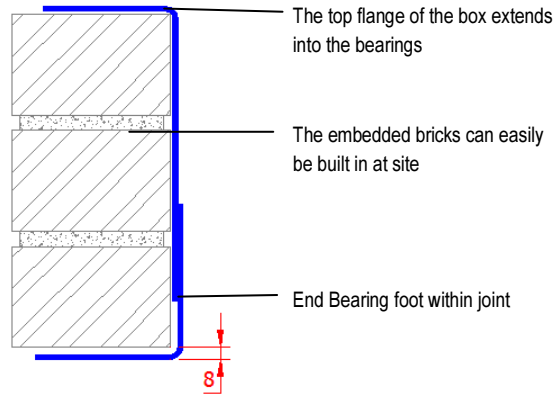

T215/3

Lintel section properties	
Ixx	320.5576 cm ⁴
Zxx	26.07 cm ³
Weight	6.51 kg/m
Area	8.14 cm
Ryy	2.42 cm

T215/4

Lintel section properties	
Ixx	431.0153 cm ⁴
Zxx	34.95 cm ³
Weight	8.70 kg/m
Area	10.88 cm
Ryy	2.44 cm

T215/6

Lintel section properties	
Ixx	657.2241 cm ⁴
Zxx	53.00 cm ³
Weight	13.13 kg/m
Area	16.41 cm
Ryy	2.48 cm

T215/4-HD

Lintel section properties	
Ixx	582.6099 cm ⁴
Zxx	45.01 cm ³
Weight	15.91 kg/m
Area	19.89 cm
Ryy	3.16 cm

Lintel load Capacity Table

Opening	Lintel Length	Safe Load
600	900	40.0
900	1200	26.6
1200	1500	20.0
1500	1800	16.0
1800	2100	13.3
2100	2400	11.4
2400	2700	10.0

Lintel load Capacity Table

Opening	Lintel Length	Safe Load
600	900	53.6
900	1200	35.7
1200	1500	26.8
1500	1800	21.4
1800	2100	17.9
2100	2400	15.3
2400	2700	13.4
2700	3000	11.9

Lintel load Capacity Table

Opening Span	Lintel Length	Safe Load kN
600	900	81.3
900	1200	54.2
1200	1500	40.6
1500	1800	32.5
1800	2100	27.1
2100	2400	23.2
2400	2700	20.3
2700	3000	18.1
3000	3300	16.3
3300	3600	14.8

Lintel load Capacity Table

Opening Span	Lintel Length	Safe Load kN
600	900	69.0
900	1200	46.0
1200	1500	34.5
1500	1800	27.6
1800	2100	23.0
2100	2400	19.7
2400	2700	17.3
2700	3000	15.3
3000	3300	13.8
3300	3600	12.5

Our unique bearings allow site brickwork to be build butting the lintel, this system gives both a high and low level bearing.

The section provides a bearing on the top flange with a second bearing at the "foot". The bricks at the bearing also fully fill between the top and bottom bearing.

Loadings are shown above to assist you in your selection 102.5mm brickwork is 2.2 kN/m² 215mm dimensions can be varied to suit imperial and other brick sizes

Brick tray

Lintel to suit 290x102 - full bricks

Section at span

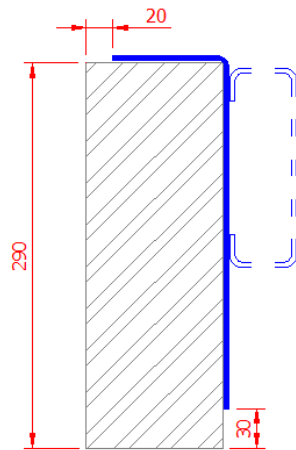

The HD option will have a back channel for increased stability

Section at bearing

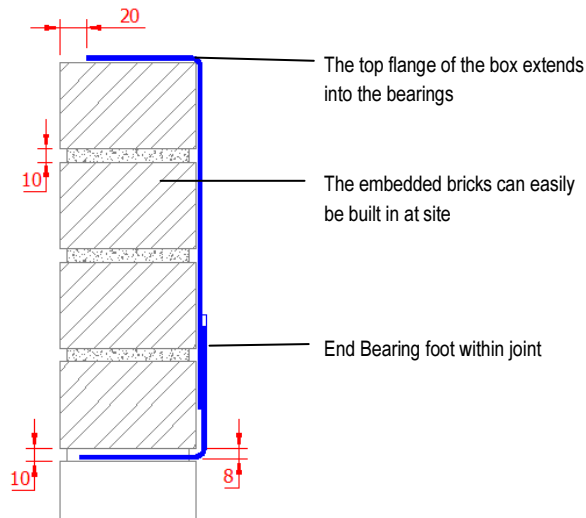

The top flange of the box extends into the bearings

The embedded bricks can easily be built in at site

End Bearing foot within joint

T290/3

Lintel section properties

Ixx	763 cm ⁴
Zxx	47.38 cm ³
Weight	8.13 kg/m
Area	10.17 cm
Ryy	1.98 cm

T290/4

Lintel section properties

Ixx	1024 cm ⁴
Zxx	63.40 cm ³
Weight	10.80 kg/m
Area	13.59 cm
Ryy	2.00 cm

T290/6

Lintel section properties

Ixx	1599 cm ⁴
Zxx	97.00 cm ³
Weight	16.70 kg/m
Area	20.91 cm
Ryy	2.20 cm

T290/4-HD

Lintel section properties

Ixx	1323 cm ⁴
Zxx	72.00 cm ³
Weight	18.30 kg/m
Area	22.89 cm
Ryy	2.90 cm

Lintel load Capacity Table

Opening Span	Lintel Length	Safe Load kN
600	900	72.6
900	1200	48.4
1200	1500	36.3
1500	1800	29.1
1800	2100	24.2
2100	2400	20.8
2400	2700	18.2
2700	3000	16.1
3000	3300	14.5

Lintel load Capacity Table

Opening Span	Lintel Length	Safe Load kN
600	900	97.2
900	1200	64.8
1200	1500	48.6
1500	1800	38.9
1800	2100	32.4
2100	2400	27.8
2400	2700	24.3
2700	3000	21.6
3000	3300	19.4
3300	3600	17.7

Lintel load Capacity Table

Opening Span	Lintel Length	Safe Load kN
600	900	148.7
900	1200	99.2
1200	1500	74.4
1500	1800	59.5
1800	2100	49.6
2100	2400	42.5
2400	2700	37.2
2700	3000	33.1
3000	3300	29.7
3300	3600	27.0
3600	3900	24.8
3900	4200	22.9

Lintel load Capacity Table

Opening Span	Lintel Length	Safe Load kN
600	900	110.4
900	1200	73.6
1200	1500	55.2
1500	1800	44.2
1800	2100	36.8
2100	2400	31.5
2400	2700	27.6
2700	3000	24.5
3000	3300	22.1
3300	3600	20.1
3600	3900	18.4

Our unique bearings allow site brickwork to be build butting the brick slip arch, this system gives both a high and low level bearing.

The section provides a bearing on the top flange with a second bearing at the "foot". Full bricks are laid up to the gauged brick eliminating the need for slips on site. The bricks at the bearing also fully fill between the top and bottom bearing.

Loadings are shown above to assist you in your selection 102.5mm brickwork is 2.2 kN/m² 215mm dimensions can be varied to suit imperial and other brick sizes

Brick tray

Lintel to suit 365x102 - full bricks

Section at span

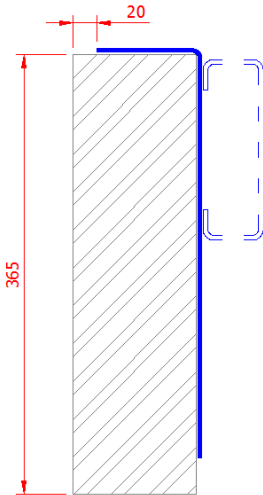

Section at bearing

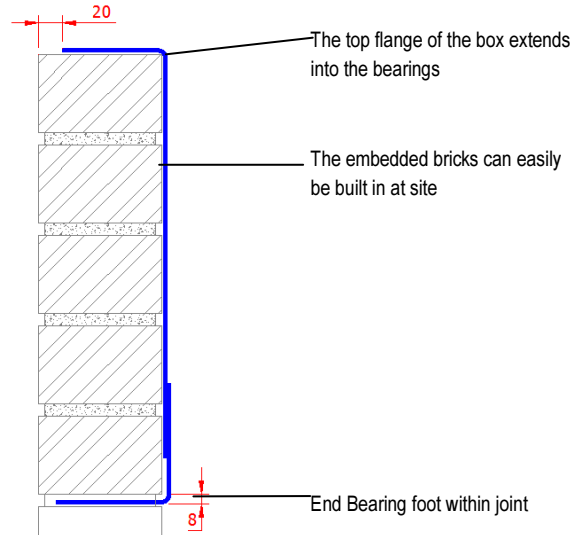

The HD option will have a back channel for increased stability

T365/3

Lintel section properties

Ixx	1540 cm ⁴
Zxx	76.10 cm ³
Weight	10.10 kg/m
Area	12.60 cm
Ryy	2.00 cm

T365/4

Lintel section properties

Ixx	2064 cm ⁴
Zxx	101.00 cm ³
Weight	13.50 kg/m
Area	16.88 cm
Ryy	2.05 cm

T365/6

Lintel section properties

Ixx	3128 cm ⁴
Zxx	153.00 cm ³
Weight	20.33 kg/m
Area	25.40 cm
Ryy	2.09 cm

T365/4 - HD

Lintel section properties

Ixx	2557 cm ⁴
Zxx	111.00 cm ³
Weight	20.50 kg/m
Area	25.70 cm
Ryy	2.75 cm

Lintel load Capacity Table

Opening Span	Lintel Length	Safe Load kN
600	900	116.7
900	1200	77.8
1200	1500	58.3
1500	1800	46.7
1800	2100	38.9
2100	2400	33.3
2400	2700	29.2
2700	3000	25.9
3000	3300	23.3
3300	3600	21.2
3600	3900	19.4

Lintel load Capacity Table

Opening Span	Lintel Length	Safe Load kN
600	900	154.9
900	1200	103.2
1200	1500	77.4
1500	1800	61.9
1800	2100	51.6
2100	2400	44.2
2400	2700	38.7
2700	3000	34.4
3000	3300	31.0
3300	3600	28.2
3600	3900	25.8
3900	4200	23.8

Lintel load Capacity Table

Opening Span	Lintel Length	Safe Load kN
600	900	234.6
900	1200	156.4
1200	1500	117.3
1500	1800	93.8
1800	2100	78.2
2100	2400	67.0
2400	2700	58.7
2700	3000	52.1
3000	3300	46.9
3300	3600	42.7
3600	3900	39.1
3900	4200	36.1
4200	4500	33.5
4500	4800	31.3

Lintel load Capacity Table

Opening Span	Lintel Length	Safe Load kN
600	900	170.2
900	1200	113.5
1200	1500	85.1
1500	1800	68.1
1800	2100	56.7
2100	2400	48.6
2400	2700	42.6
2700	3000	37.8
3000	3300	34.0
3300	3600	30.9
3600	3900	28.4
3900	4200	26.2
4200	4500	24.3

Our unique bearings allow site brickwork to be build butting the brick slip arch, this system gives both a high and low level bearing.

The section provides a bearing on the top flange with a second bearing at the "foot". The bricks at the bearing also fully fill between the top and bottom bearing.

Loadings are shown above to assist you in your selection 102.5mm brickwork is 2.2 kN/m² 215mm dimensions can be varied to suit imperial and other brick sizes